

River courses
 N 66 W 5
 N 54 1/2 W 52
 N 43 W 28
 N 28 W 23
 N 45 W 30
 N 72 1/2 W 13
 PS 151

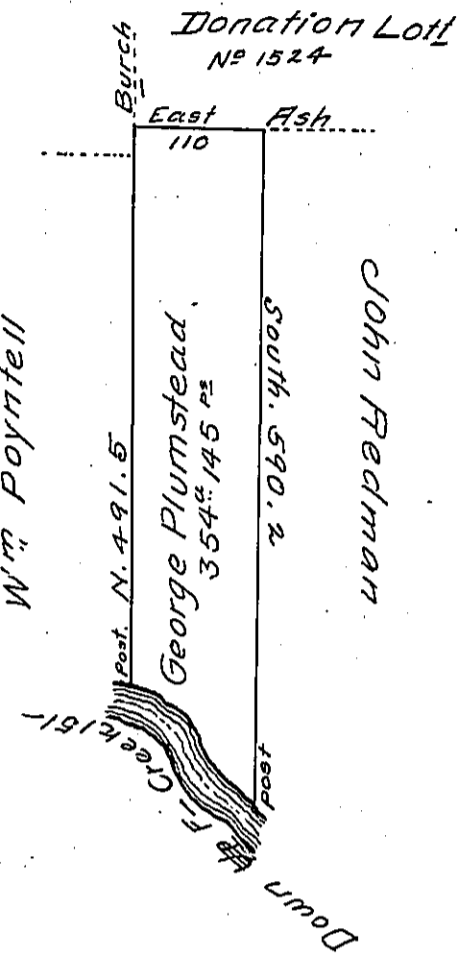

Situate on and adjoining the West Side of French Creek in Allegheny County containing 354 1/2 145 ps and allowance of six p Cent for roads &c. Surveyed the 29th day of October 1795 in pursuance of a warrant dated 13th Apr 1792

Wm Power D^r SE

To Danl Brodhead Esqr
 Surveyor General.

IN TESTIMONY that the above is a copy of the original remaining on file in the Department of Internal Affairs of Pennsylvania, made conformably to an Act of Assembly approved the 16th day of February, 1833, I have hereunto set my Hand and caused the Seal of said Department to be affixed at Harrisburg, this twenty-fifth day of June 1906

Goac R Brown
 Secretary of Internal Affairs.